

Punto.1 /2Touch

Spot led quadrato/tondo integrato



CARATTERISTICHE TECNICHE

- CLASSE III ISOLAMENTO
- GRADO IP 20
- CONFORME NORMATIVA CE

Finitura

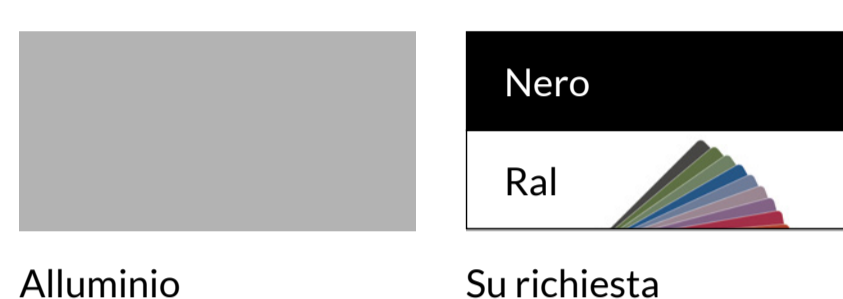

Soluzioni Ambiente

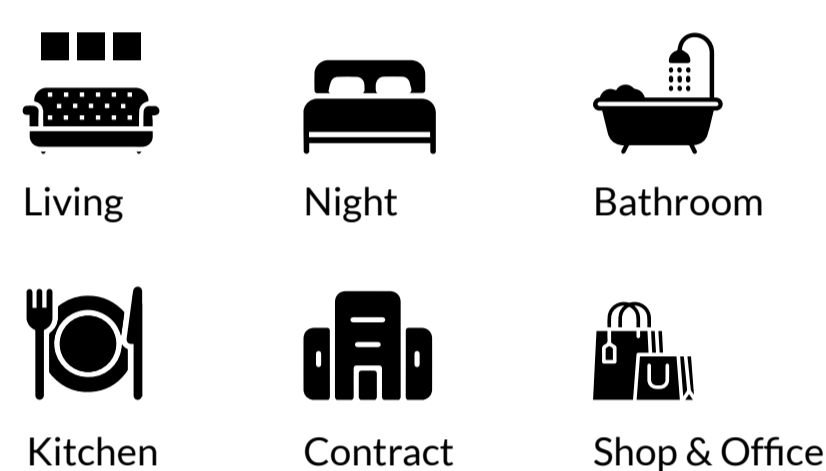

Posizionamento

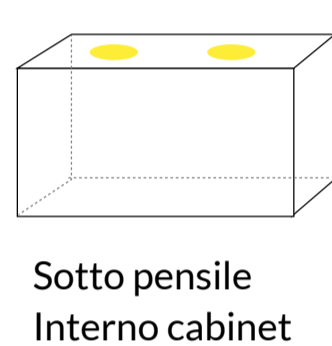

Dimensioni mm

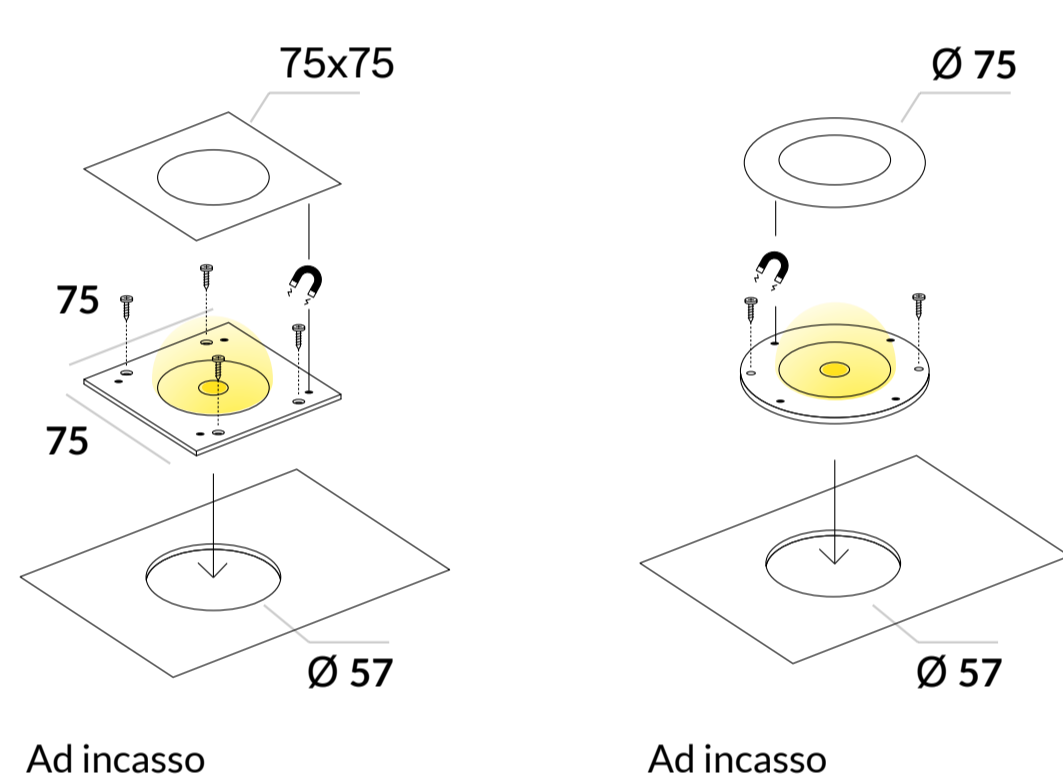

Punto.1 Touch

L mm	W	K	Vdc	CRI	≡
75x75	2,5	3000 4000	12	>80	2000 mm

Punto.2 Touch

Ø mm	W	K	Vdc	CRI	≡
75	2,5	3000 4000	12	>80	2000 mm

Fotometria

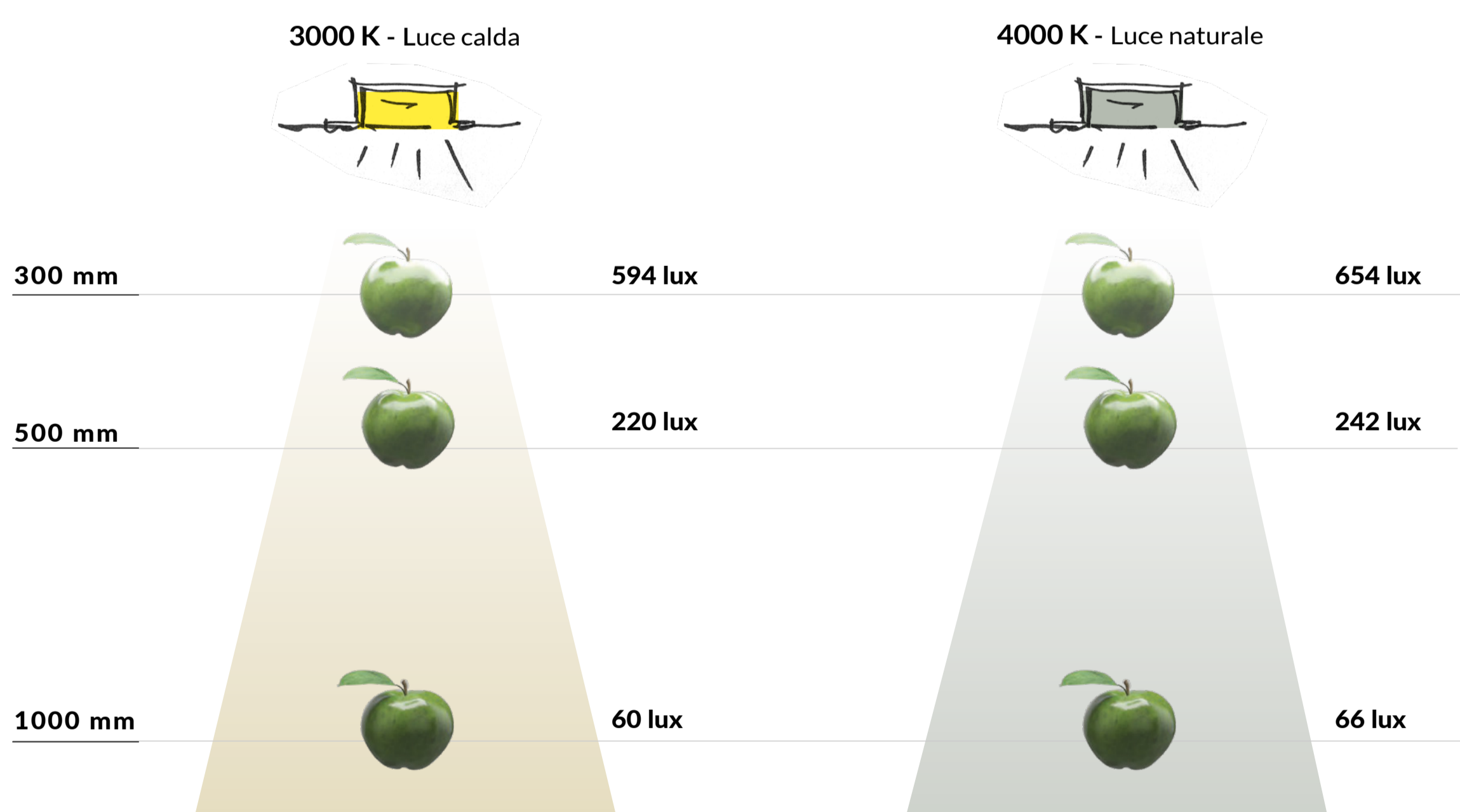

SOLUZIONI DI ACCENSIONE



TOUCH sensor - Punto.1
Accensione Touch con funzioni on-off e dimer.

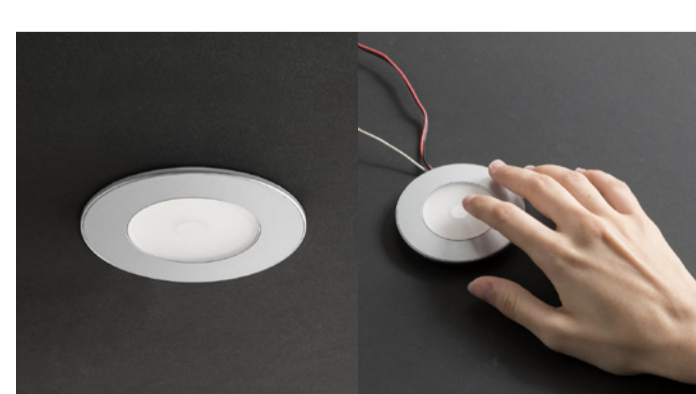

TOUCH sensor - Punto.2
Accensione Touch con funzioni on-off e dimer.